

Fittings aus Messing

Brass fittings

Raccorderia Filettata Generica in Ottone

Technische Daten

Betriebstemperatur	max. +150 °C	
Betriebsdruck	bis 60 bar	
Werkstoffe	Messing vernickelt und blank	CW614N und CW617N
Gewinde	DIN 3852 DIN 3858	
Medium	Luft, Wasser, Öl, Dampf, etc.	

Technical Data

Operating temperature	max. +150 °C	
Operating pressure	Up to 60 bar	
Materials	Brass nickel-plated and polished	CW614N and CW617N
Thread	DIN 3852 DIN 3858	
Medium	Air, water, oil, steam, etc.	

Dati tecnici

Temperatura di esercizio	Max. +150 °C	
Pressione di esercizio	Fino a 60 bar	
Materiali	Ottone (Ms58) nichelato o lucidato	
Filetto	DIN 3852 DIN 3858	
Fluidi utilizzabili	Aria compressa, acqua calda e fredda, olio, vapore, olii e liquidi industriali a richiesta	

RC220

konisch

Detachable conical double nipple, nickel-plated
Niplo M.M. conico orientabile, nichelato

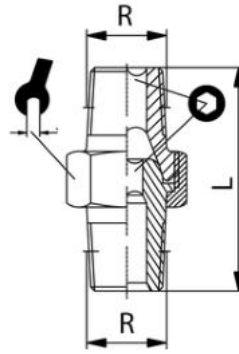

Code	R	L	Ø	Ø
RC220-1/8-1/8	R1/8	27,5	15	5
RC220-1/4-1/4	R1/4	33,5	19	6
RC220-3/8-3/8	R3/8	37	22	8
RC220-1/2-1/2	R1/2	44,5	27	12
RC220-3/4-3/4	R3/4	54,5	36	14
RC220-1-1	R1	65	46	19